

APPENDIX TO USER MANUAL – USE OF SUPER DUPLEX CONNECTION PLATE

Super Duplex Connection Plate is the term used for a connection point in ScaleAQ's nets, serving as an alternative to traditional rope knots. The component is illustrated in Figure 1, as well as in images from the ScaleWorld model in Figure 2 and 3.

During service of a connection point with Super Duplex Connection Plate where the rope needs replacement, the same type of rope must be spliced into the framework. The eye connecting to the Super Duplex Connection Plate should be protected with heat shrink tubing. This procedure also applies to new production of nets.

When washing the net at a service station, it is recommended to protect the Super Duplex Connection Plate, especially when using a washing machine.

The Super Duplex Connection Plate offers high capacity against flow and is designed with safety factors in accordance with current aquaculture regulations.

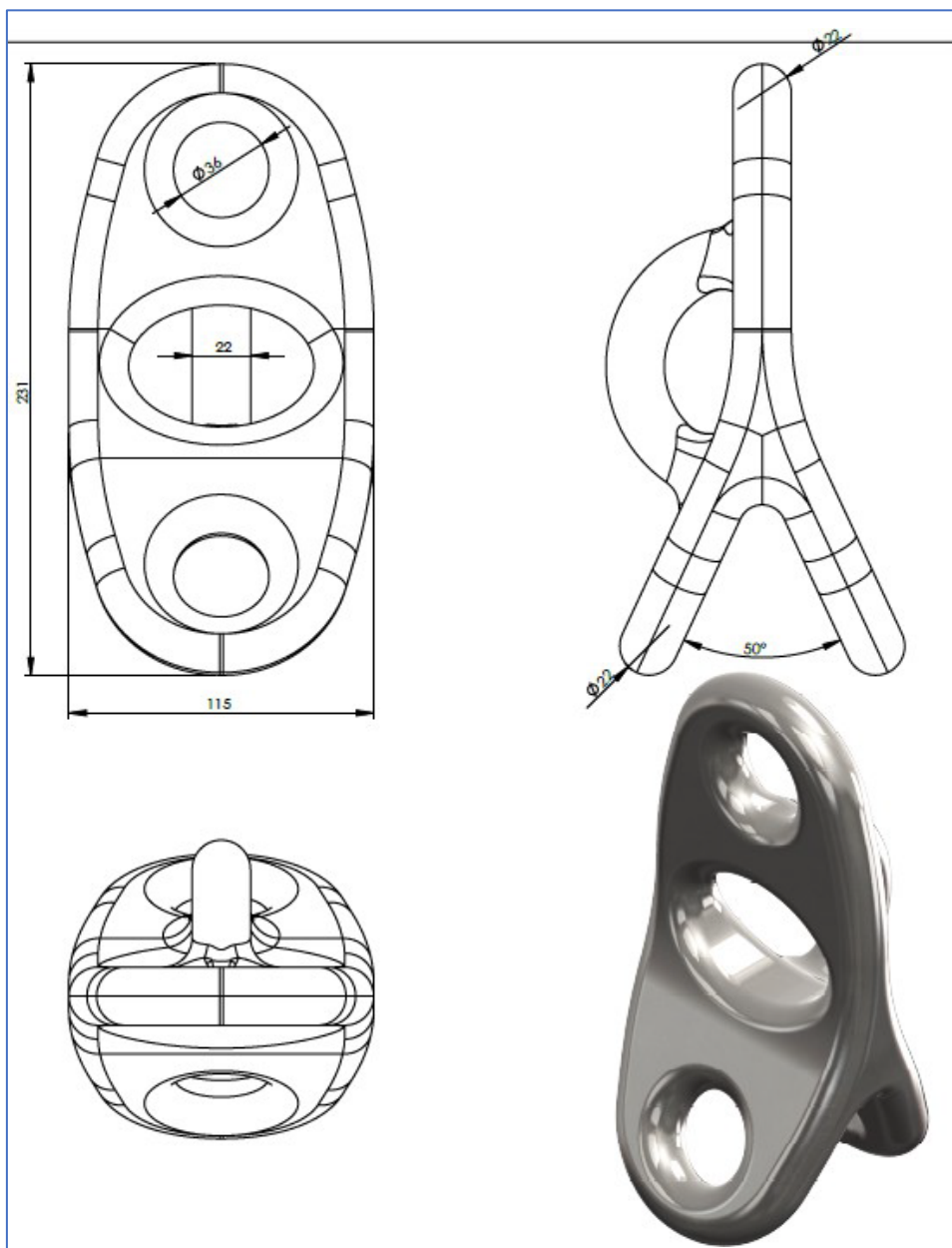

Figure 1: Super Duplex Connection Plate



Figure 2: Super Duplex Connection Plate at bottom rope cross-points

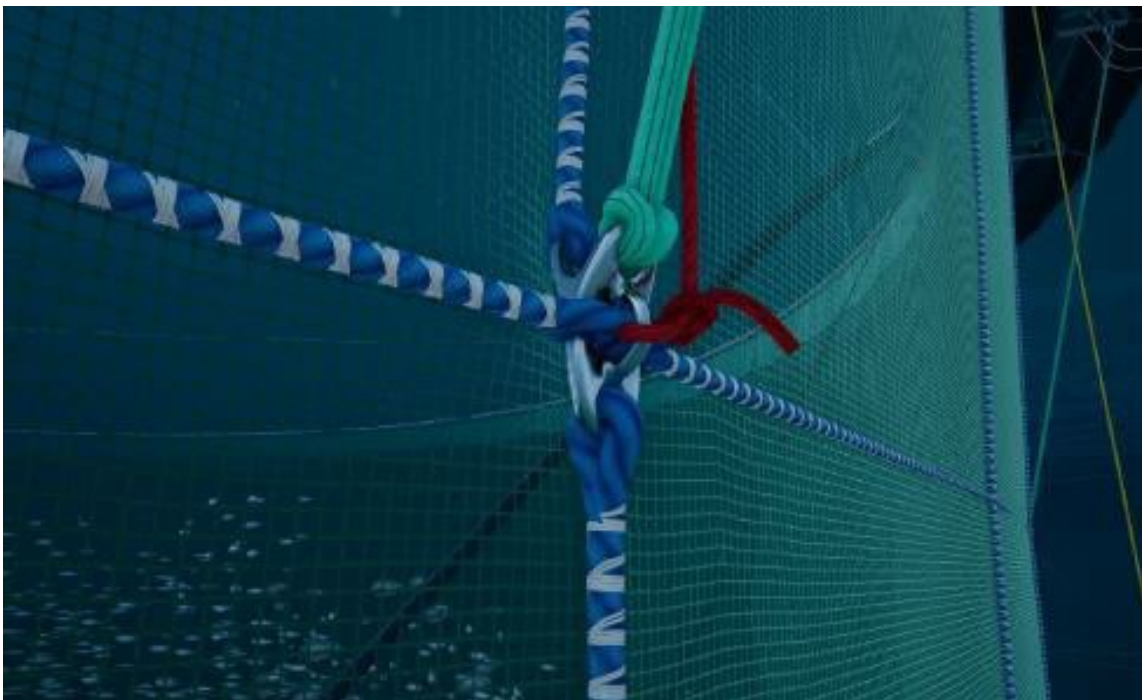

Figure 3: Super Duplex Connection Plate at Midgard intersection at waistrope

Allowed loads against the Super Duplex Connection Plate are shown in Figure 4.

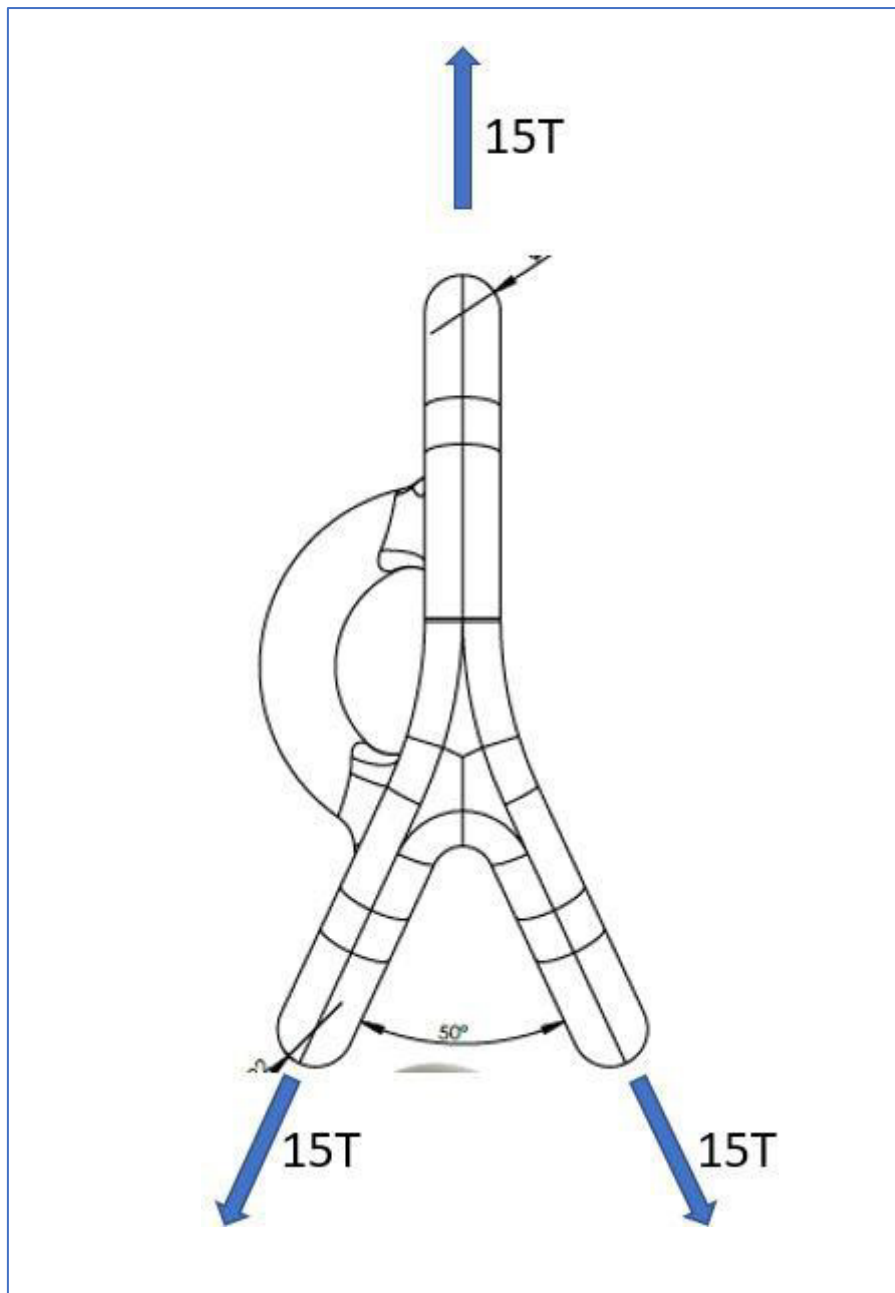

Figure 4: Allowed loads against the Super Duplex Connection Plate